

SmartTester Interface Cable Kits*



SISVK SmartTester Interface Kit/SmartValve™ Use with Honeywell 1st Generation SmartValve™ (no LED)

Includes:

- SmartValve™ Cable (HWSV)
- SmartValve™ Smart Card (HWSVC)
- Flow Chart
- Soft Carrying Case (SCCP)

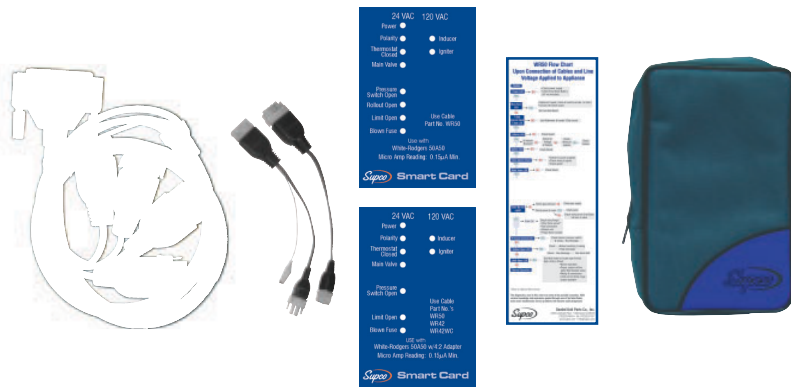

SI50K SmartTester Interface Kit/50A Series Use with White Rodgers 50AXX Series

Includes:

- 50A Series Cable (WR50)
- 4:2 Adapter Cable (WR42)
- 4:2 Adapter Cable w/Clip (WR42WC)
- 50A Series Smart Cards (WR50C, WR5042C)
- Flow Chart
- Soft Carrying Case (SCCP)

NEW

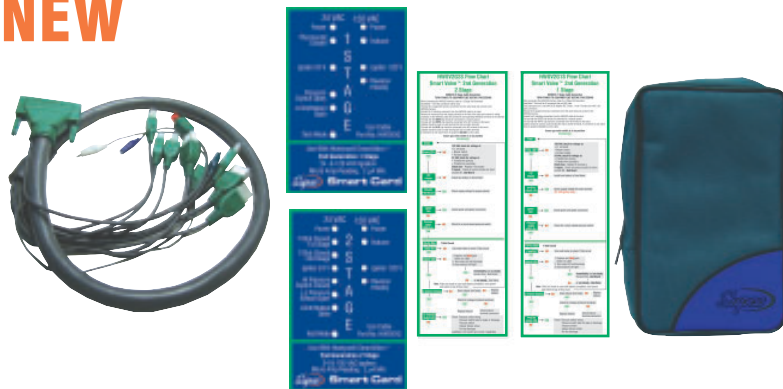

SISV2GK SmartTester Interface Kit/SmartValve™ 2nd Generation Use with 2nd Generation SmartValve™ (Valves w/3 connections & LED)

Includes:

- SmartValve™ Cable (HWSV2G)
- SmartValve™ Smart Cards (HWSV2G1SC 1 Stage, HWSV2G2SC 2 Stage)
- Flow Charts
- Soft Carrying Case (SCCP)

NEW

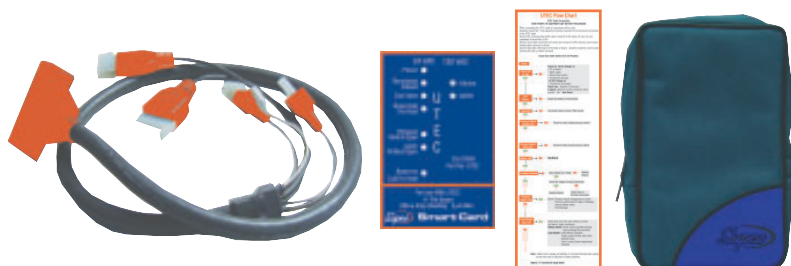

SIUTECK SmartTester Interface Kit/UTEC Use with Products by ICP & Carrier (UTEC Straight 11 Pin Boards)

Includes:

- UTEC Cable (UTEC)
- UTEC Smart Card (UTECSC)
- Flow Chart
- Soft Carrying Case (SCCP)

* **Notes:** Interface Cable Kits Do Not Include the SmartTester Instrument.