

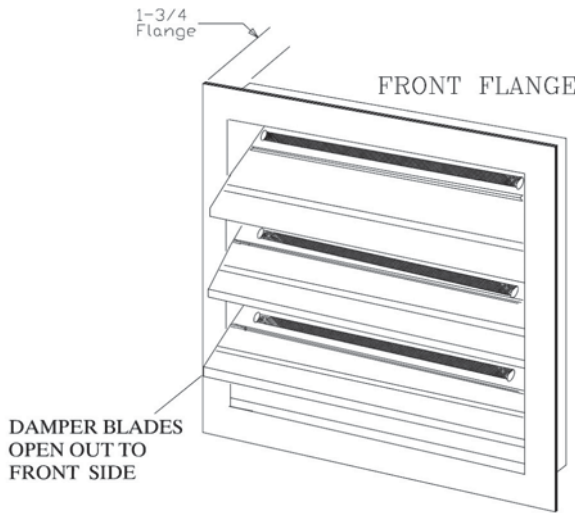

BACKDRAFT DAMPER

MODELS:
LBDF-2 with Front Flange



APPLICATION

The LBD-2 is Lloyd's vertical/horizontal mounted Backdraft Damper that is designed to allow vertical/horizontal airflow and prevent reverse airflow. The damper is opened by air pressure differential and closed by gravity.

OPTIONAL BLADE COUNTERWEIGHTS:
Counterweights available on request

Note: Dampers will be provided less counterweights unless specified.

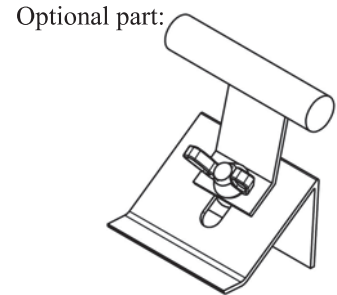

STANDARD CONSTRUCTION

FRAME:	6063T5 Extruded Aluminum Minimum wall thickness 16 ga.	AXLES:	Cast Aluminum
BLADES TYPE:	6063T5 Extruded Aluminum 16 ga. Counter balance rod Holder Built into rear of blades	LINKAGE:	16 ga. x 5/8" wide Aluminum Concealed in the channel frame
SEALS:	Vinyl Blade	ORIENTATION:	Horizontal or vertical
		FINISH:	Mill Finish

MODEL AND MOUNTING SELECTION

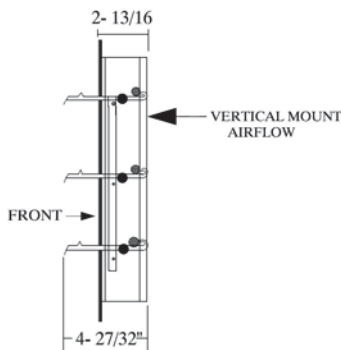

- MODEL: LBDF-2
- Vertical Installation
 - Flangeless Duct Mounting

- MODEL: LBDF-2
- Horizontal Installation

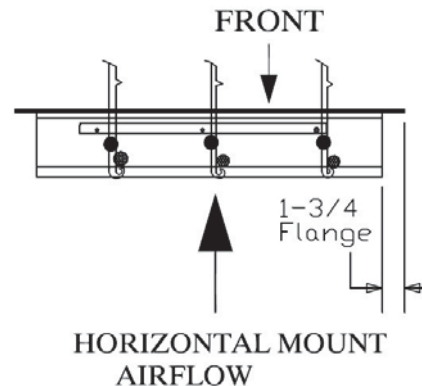

Single Section		Multiple Section
Minimum Size (WxH)	Maximum Size (WxH)	Maximum Size (WxH)
6"x6"	36"x60"	UNLIMITED

NOTE:

When used in fan discharge applications, damper should be at least half the fan diameter distance from fan discharge.

Damper is 1/4" less than ordered dimensions unless specified "ACTUAL SIZE".





BACKDRAFT DAMPER



MODELS:
LBD-1
LBDF-1 (with rear flange)

APPLICATION

The LBD-1 is Lloyd's vertical/horizontal mounted Backdraft Damper that is designed to allow vertical/horizontal airflow and prevent reverse airflow. The damper is opened by air pressure differential and closed by gravity.

OPTIONAL BLADE COUNTERWEIGHTS:
Counterweights available on request

Note: Dampers will be provided less counterweights unless specified.

Optional part:

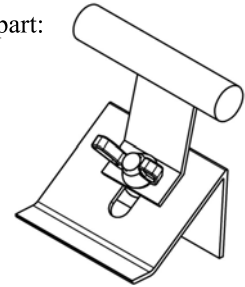

STANDARD CONSTRUCTION

- FRAME:** 6063T5 Extruded Aluminum
Minimum wall thickness 16 ga.
- BLADES TYPE:** 6063T5 Extruded Aluminum 16 ga.
Counter balance rod Holder
Built into rear of blades
- SEALS:** Vinyl Blade
- AXLES:** Cast Aluminum
- LINKAGE:** 16 ga. x 5/8" wide Aluminum
Concealed in the channel frame
- ORIENTATION:** Horizontal or vertical
- FINISH:** Mill Finish

MODEL AND MOUNTING SELECTION

MODEL: LBD-1

- Vertical Installation
- Flangeless Duct Mounting

MODEL: LBDF-1

- Vertical Installation
- Flange Mount

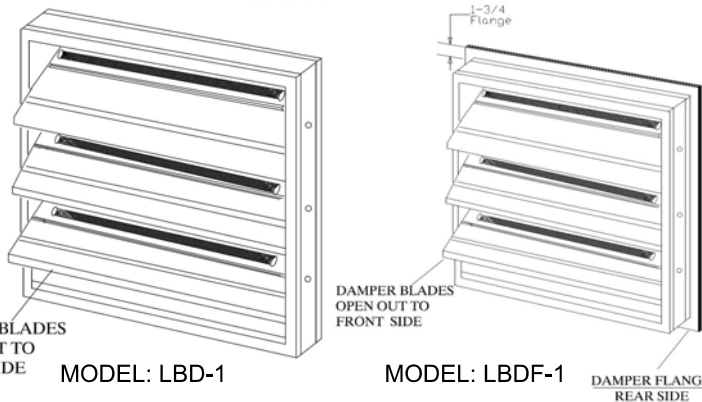
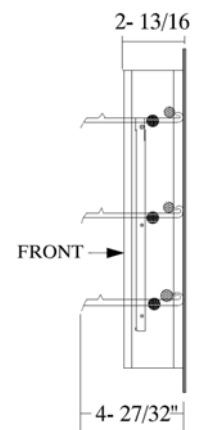
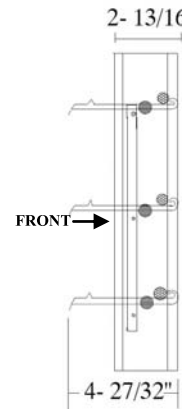

MODEL: LBD-1

- Horizontal Installation with Upward Airflow

MODEL: LBDF-1

- Horizontal Installation with Upward Airflow

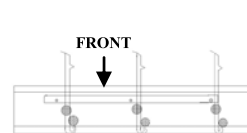

NOTE:

When used in fan discharge applications, damper should be at least half the fan diameter distance from fan discharge.

Damper is 1/4" less than ordered dimensions unless specified "ACTUAL SIZE".

Single Section		Multiple Section
Minimum Size (WxH)	Maximum Size (WxH)	Maximum Size (WxH)
6"x6"	36"x60"	UNLIMITED

231 Commerce Dr. Montgomeryville, PA 18936
Tel: 215-412-4445 Fax: 215-412-4409
Email: lloydind@firedamper.com

138 Industrial Loop West, Orange Park, FL 32073
Tel: 904-541-1655 Fax: 904-541-1657
Email: lloydind1@bellsouth.net

B1, 4/F., Luen Ming Hing Factory Building
36 Mok Cheong St.,
To Kwa Wan, Kowloon, H. K.
Tel: 852-2760-4188 Fax: 852-2760-4177
Email: tatanlexyim@lloydasia.com



Lloyd Industries Inc. 2013

BACKDRAFT DAMPER

OPERATION OF OPTIONAL BLADE COUNTERWEIGHTS:

Figure 1

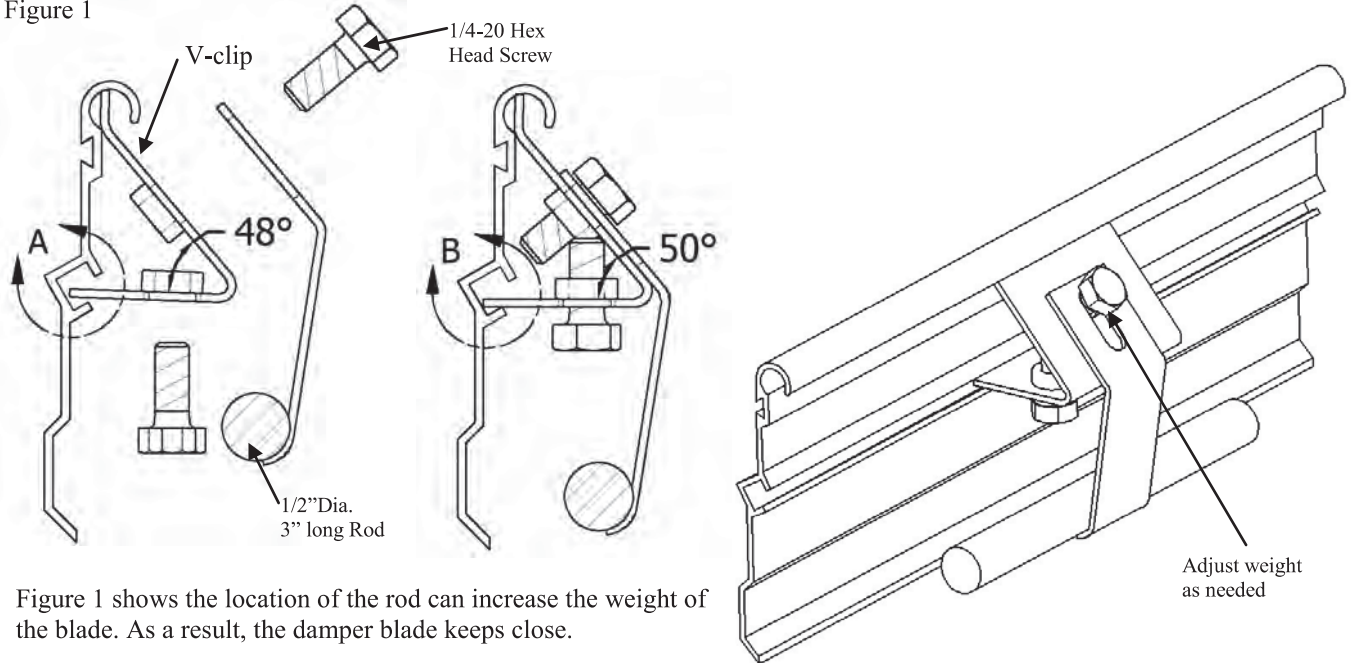

Figure 1 shows the location of the rod can increase the weight of the blade. As a result, the damper blade keeps close.

Figure 2

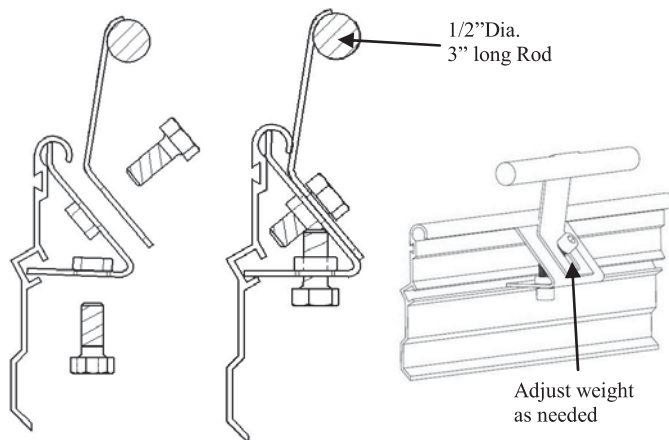

Figure 2 shows the rod on the opposite direction. At this location, the rod helps to increase the gravity instead of the blade's weight. As a result, the damper blade keeps open.

Figure 3

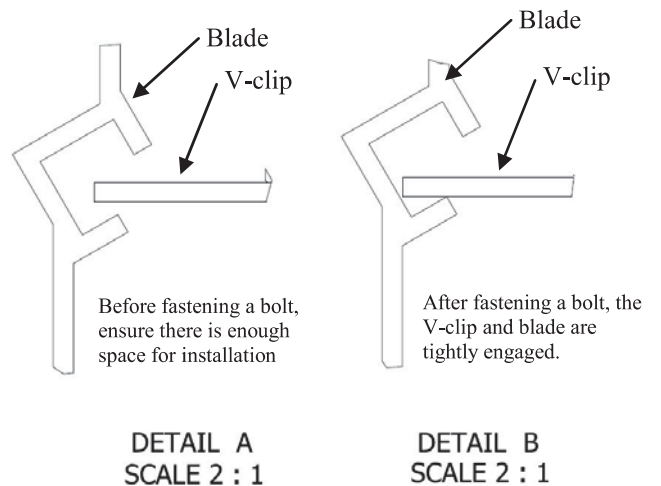

Figure 3 illustrates how the V-clip and blade are engaged.