

6375FD STATIONARY LOUVER

ROLL FORMED STEEL

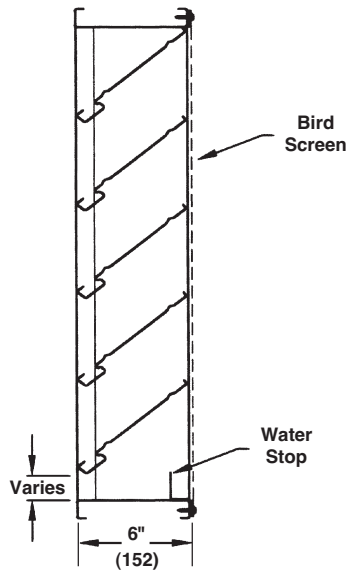
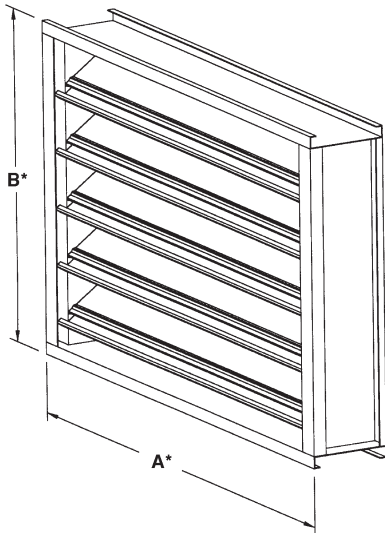

STANDARD CONSTRUCTION

FRAME
6" (152) deep, 18 gage (1.3) galvanized steel.

BLADES
18 (1.3) gage galvanized steel. Drainable blades are positioned at 37¹/₂° angle and spaced approximately 4³/₄" (121) center to center.

SCREEN
1/2" mesh x 19 gage (13 x 1.1) galvanized bird screen in removable frame. Screen adds approximately 1/2" (13) to louver depth.

FINISH
Mill.

MINIMUM SIZE
12"w x 12"h (305 x 305).

APPROXIMATE SHIPPING WEIGHT
5 lbs. per sq. ft (24.4 kg/m²)

MAXIMUM FACTORY ASSEMBLY SIZE
64 square feet (6m²) per section, not to exceed 60"w x 120"h (1524 x 3048) or 120"w x 60"h (3048 x 1524).

Louvers larger than the maximum factory assembly size will require field assembly of smaller sections.

SUPPORTS
Louvers may be provided with rear mounted blade supports that increase overall louver depth depending on louver size, assembly configuration or windload.

Consult Reliable for additional information.

FEATURES

- The 6375FD:
- 54% Free Area.
 - Published performance ratings based on testing in accordance with AMCA Publication 511.
 - Drain gutters in each blade and downspouts in jambs and mullions to drain water from louver for minimum water cascade from blade to blade.
 - Low pressure drop and low water penetration.
 - Hidden vertical blade supports allow continuous blade appearance up to 120"w (3048).
 - Economical galvanized steel construction.

VARIATIONS

Variations to the basic design of this louver are available at additional cost. They include:

- Extended sill.
- Hinged frame.
- Front or rear security bars.
- Filter racks.
- Installation angles.
- A variety of bird and insect screens.
- Heavier, 16 gage (1.6) construction.
- Formed stainless steel construction with 18 gage (1.3) or 16 gage (1.6) frame and blades.
- Selection of finishes: prime coat, baked enamel (modified fluoropolymer), epoxy, Acrodize and Kynar.

Consult Reliable for other special requirements.

FRAME CONSTRUCTION

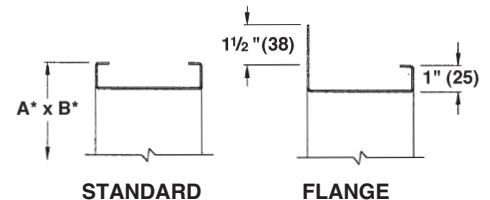

Dimensions in inches, parenthesis () indicate millimeters.

*Units furnished 1/4" (6) smaller than given opening dimensions.

TAG	QTY.	SIZE		FRAME	VARIATIONS
		A*-WIDE	B*-HIGH		

PROJECT
ARCH./ENGR.
REPRESENTATIVE



LOCATION
CONTRACTOR
DATE

TYPICAL INSTALLATION DETAILS

**Masonry
Wall**

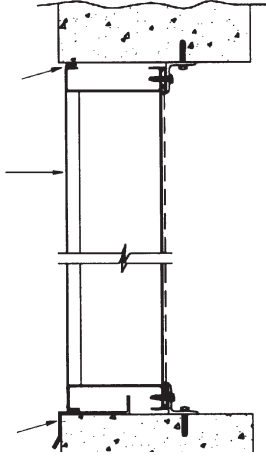

**Metal Panel
Wall**

**Flange
Mount**

**Angle
Subframe
(Optional)**

STANDARD CONSTRUCTION DETAILS

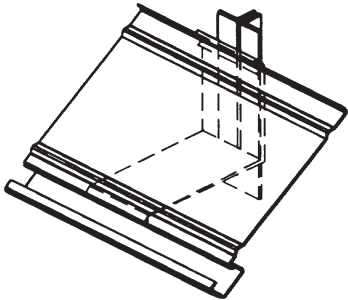

**Hidden Vertical Blade
Support (HVBS)
Available up to 120" (3048)**

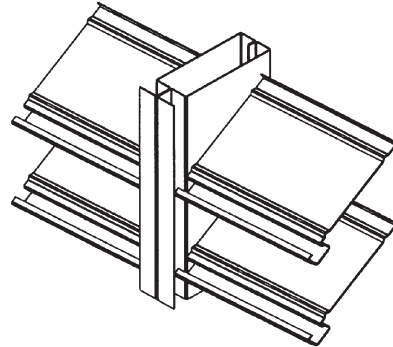

**Visible Mullion
At Section Joints**